



**PepperBall®**

---

# **3L MOBILE FILL BOTTLE AND WHIP 4500 PSI**

---

**QUICK START GUIDE**

## 3L BOTTLE OVERVIEW

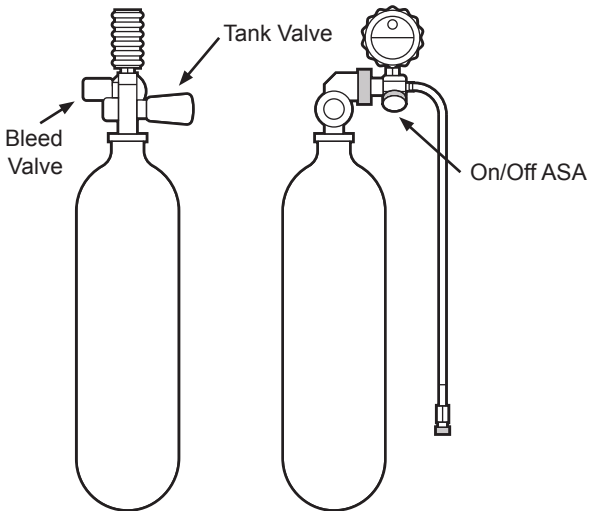

## INITIAL SETUP

1. Unbox tank assembly in pouch and air control valve.
2. Remove plug from face of tank valve.
3. Remove thread protector from air control valve.
4. Insert air control valve into valve face, aligning threads and threading in until completely seated.

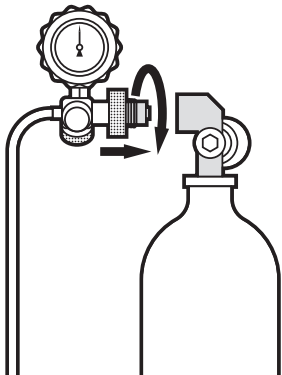

## FILLING 3L TANK

**IMPORTANT SAFETY NOTICE:** Before filling any cylinder confirm the maximum filling pressure. The two common filling pressures are 3000 psi or 4500 psi. **NEVER FILL A CYLINDER BEYOND THE RATED FILLING PRESSURE.**

1. Ensure tank valve is turned in (clockwise) and seated.
2. Ensure ON/OFF ASA is turned out (counterclockwise) in the open position. **NOTE:** This rotation is as you are looking at the knob. You will see the rear of the gauge as a reference.
3. Ensure the bleed valve is turned in (clockwise) and seated.

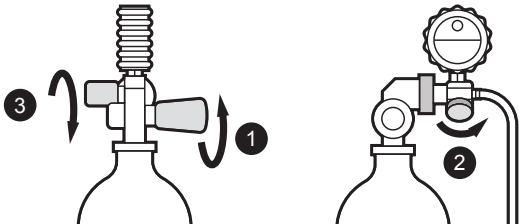

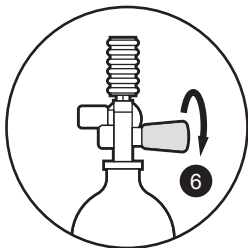
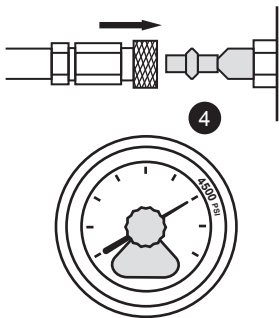

4. Attach fill whip to air source.
  - If using the PepperBall® portable compressor, ensure Fill Gauge is set to 4500 psi.
5. Engage air fill source.
6. Slowly turn tank valve counterclockwise to open. The tank should begin filling.

7. Watch gauge on air control valve and stop fill when 4500 psi is reached. 3000 psi is acceptable if the air source is not capable of producing 4500 psi.
- If using the PepperBall® portable compressor, it will stop when 4500 psi is reached.
  - **If using another air fill source, do not overfill the tank.**
  - Never leave a tank unattended while being filled.
8. Once the tank is full, immediately turn the tank valve clockwise until seated. Leaving a charged cylinder with an open valve attached to a compressor will allow the pressure to bleed back through the system, eventually emptying the cylinder.

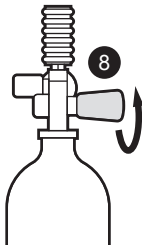
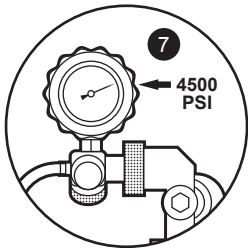

9. Turn bleed valve (on air control valve) counterclockwise to vent fill whip.
10. Turn bleed valve (on air control valve) clockwise until seated to close vent.
11. Turn On/Off ASA clockwise until seated to close air path.
12. Disconnect fill whip from air source.

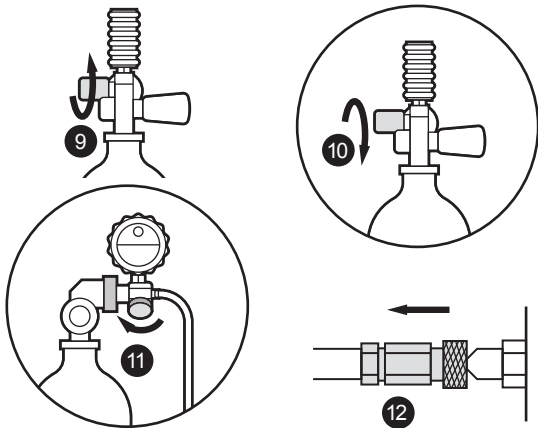

## USING 3L TANK TO FILL TANKS

**IMPORTANT SAFETY NOTICE:** Before filling any cylinder confirm the maximum filling pressure. The two common filling pressures are 3000 psi or 4500 psi. **NEVER FILL A CYLINDER BEYOND THE RATED FILLING PRESSURE.**

1. Ensure On/Off ASA is turned out (counterclockwise) in the open position.
2. Ensure the Bleed Valve is turned in (clockwise) and seated.

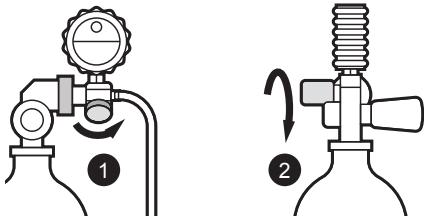

3. Connect the Fill Whip to the fill nipple on the tank.
4. Turn the Tank Valve **SLOWLY** counterclockwise to open and begin filling.

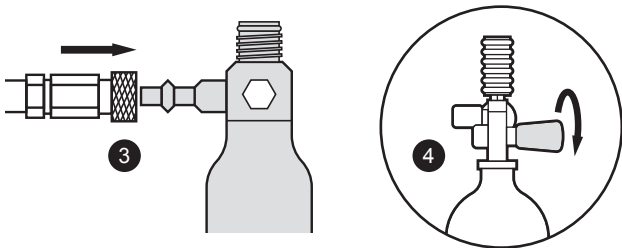

**NOTE:** To prevent moisture contamination, do not invert the 3L tank when filling other units. If tank inversion must happen, be sure to bleed a small amount of air through the fill whip before filling to help discharge accumulated moisture.

5. Once the tank reaches the desired fill pressure, follow these steps:
- Close the tank valve.
  - Close the ON/OFF ASA.
  - Vent the system using the bleed valve.
  - Detach the fill whip.

**Note:** If the fill whip does not detach, it means the system is still pressurized. Use the bleed valve to release the remaining pressure.

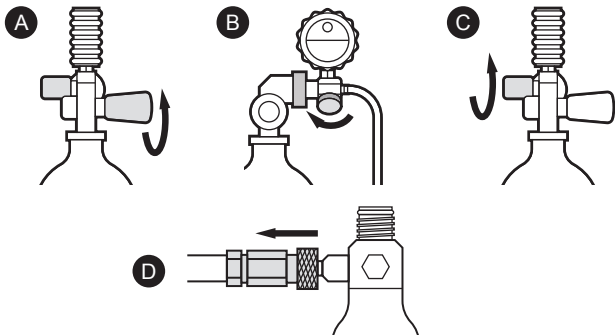

# TROUBLESHOOTING

**Q:** Unit is leaking where on/off attaches to the tank valve.

**A:** Ensure there is no debris on the seal of the on/off valve and that it is seated completely onto the tank valve.

**Q:** Attached tank will not fill after opening the tank valve.

**A:** Ensure that the on/off is open to allow air to flow from the 3L tank to the connected tank.

**Q:** Burst discs keep rupturing on the tanks I am filling.

**A:** This is not a regulated system, and careful attention needs to be paid to the pressure gauge on the tank being filled. The 3L tank can hold up to 4500 psi and over pressurization is possible.

**Q:** The on/off is open but I keep getting a leak when opening the tank valve.

**A:** Ensure that the bleed valve is closed before opening the tank valve.

**Q:** My tank is filled but I can't remove the fill whip.

**A:** Ensure the tank valve is closed and the bleed valve is open to release the pressure in the system. This will allow the fill whip to be removed.

**WARNING: THIS PRODUCT IS NOT A TOY. KEEP AWAY FROM CHILDREN.** There may be state or local restrictions on the purchase, possession, and use of the 3L Mobile Fill Bottle with Whip 4500 PSI. Verify the legal requirements in your state and city to ensure proper possession and use. The user assumes liability for unsafe or improper use or any actions that violate applicable laws or regulations. The 3L Mobile Fill Bottle with Whip 4500 PSI may be prohibited in certain locations, including government buildings, airports, courthouses, schools, or other public spaces, and its use may subject the user to criminal liability.

**⚠ DO NOT OVERFILL AIR CYLINDERS OR AIR TANKS. OVERFILLING CAN CAUSE SERIOUS INJURY OR DEATH.**

**⚠ THIS IS NOT A REGULATED SYSTEM, AND CAREFUL ATTENTION NEEDS TO BE PAID TO THE PRESSURE GAUGE ON THE TANK BEING FILLED.**



PepperBall® A Division of United Tactical Systems, LLC  
28101 Ballard Drive, Suite F  
Lake Forest, IL 60045  
**PepperBall.com | (877) 887-3773**

092425